

BJCC South Hall

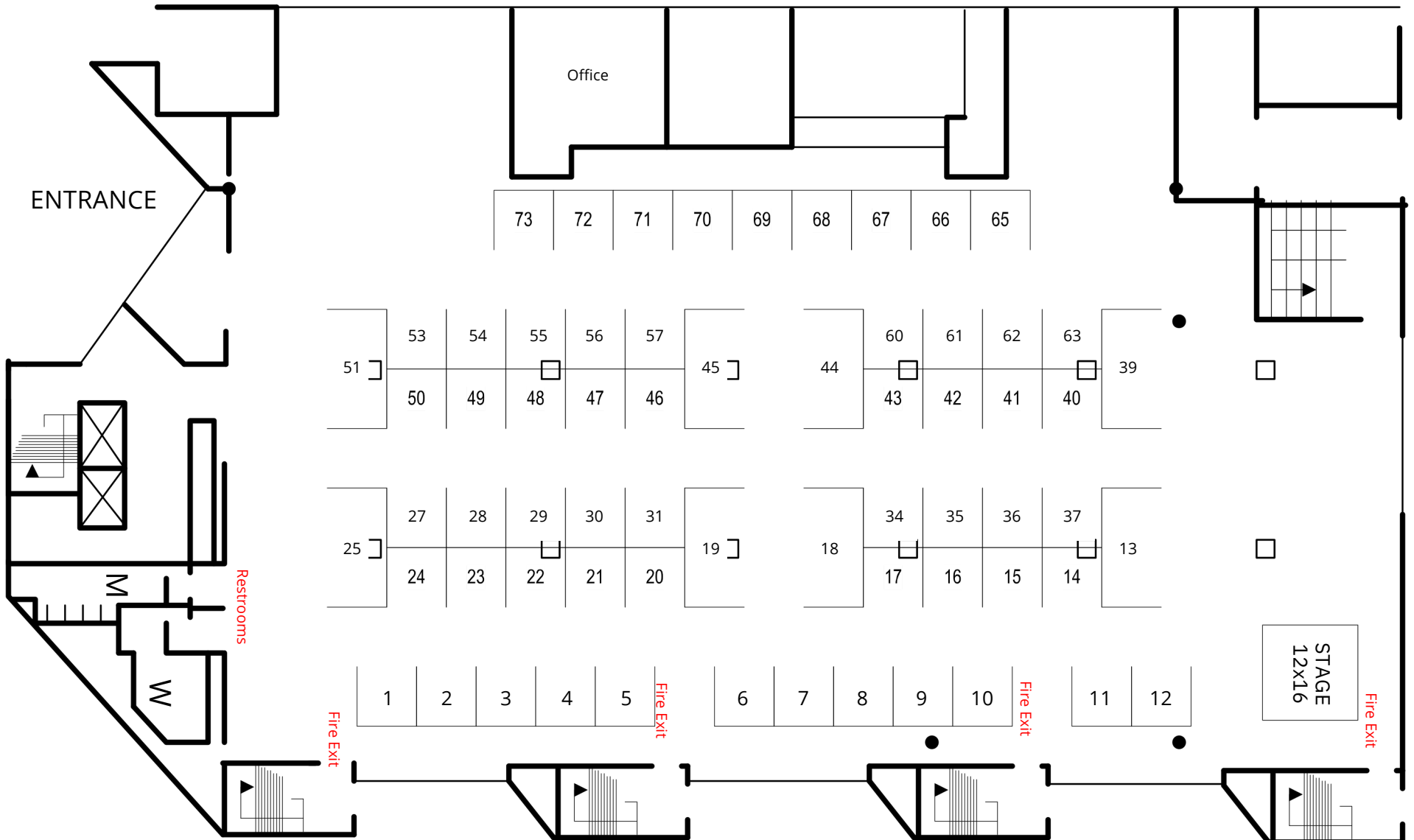

MAGIC CITY EXPO
2025

Exhibitor Floor Plan & Booth Selection

Choosing the right booth can make all the difference in your expo experience. To help you make the most of your presence at the Magic City Expo, we've outlined some key booth details and instructions below.

Prime Locations: Corner Booths

Booths #1, 5, 6, 10, 11, 12, 65, and 75 are corner booths. These spaces are considered premium locations because they offer increased visibility and accessibility from multiple directions. More exposure means more foot traffic—giving you the advantage of capturing the attention of more attendees throughout the day.

Featured Sponsor Booths (Unavailable)

The following booths are reserved for our featured sponsors and are not available for general exhibitor selection: **#51, 25, 45, 19, 44, 18, 39, and 13**. These booths are centrally located and receive additional exposure as part of our sponsorship packages.

Booth Selection Instructions

- Review the floor plan carefully and choose your top three (3) booth preferences.
- Booth assignments are made on a first-come, first-served basis upon receipt of full payment.
- We will do our best to accommodate your preferences based on availability at the time your payment is received.

Make Your Move!

Choosing a strategic booth location is the first step in maximizing your success at the Magic City Expo. Reserve your space today and set yourself up for an unforgettable experience that connects you with new customers, builds your network, and drives your business forward!